

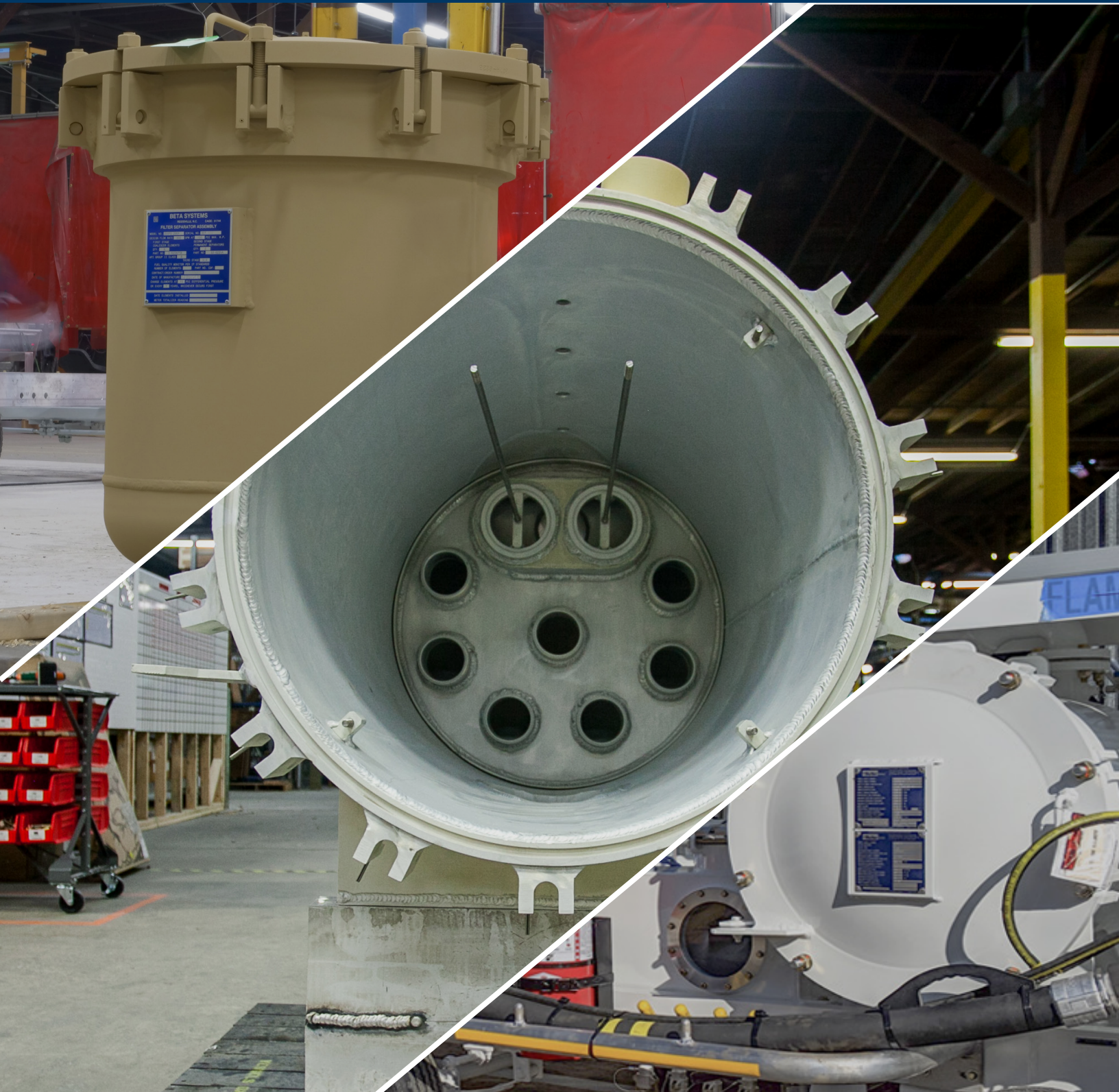

Mobile Fuel Filtration Catalog

Turn Your Fuel Into Profit



RELIABILITY | SUPPORT | DELIVERY

About Our Vessels



Fuel Filtration Vessels

BETA is an ASME U-stamp certified manufacturing facility approved to manufacture and validate fuel filtration vessels for use in global aviation. BETA's aluminum and stainless steel vessels eliminate the risk of internal epoxy damage that commonly occurs in the field with carbon steel vessels.

BETA is the only commercial aviation refueling vehicle manufacturer certified to manufacture code-stamped vessels. BETA also carries additional certifications including R-stamp for refurbishment and repair inhouse or infield.

From 50 GPM to over 1200 GPM flow rates, BETA is capable of manufacturing a full range of designs and performance requirements to ensure your fuel is clean and dry.



Filter/Water Separators

Filter/water separators are two-stage filter vessels designed to remove ultra-fine contamination and separate water from petroleum-based fuels.

- Aluminum or stainless steel construction
- Qualified to 6th Edition of EI 1581
- EI 1596 Design & Construction
- Built to ASME Code, Section VIII, stamped and certified
- Easy to service / low maintenance



Water Barrier/DDF/Monitor

Water Barrier, Dirt Defense or Monitor vessels available. The same housing is used for each and only the elements change.

- Qualified to latest edition of EI 1583, EI 1588 or EI 1599
- Aluminum or stainless steel construction
- EI 1596 Design & Construction
- Built to ASME Code, Section VIII, stamped and certified
- Easy to service / low maintenance

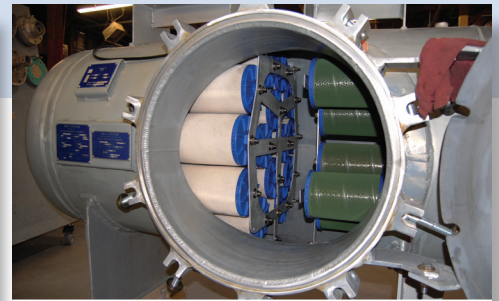

Filter Cartridges / Elements

BETA provides a complete line of cartridge sets qualified to test to the latest EI 1581 for use in Filter/Separators.

All filter monitor cartridges are qualified to the EI Monitor specifications.

This family of cartridges provides optimum filtration performance when used in Velcon filter vessels or in vessels manufactured by Facet or Faudi.

Filter/Separators

EI 1581, 6th Edition, Category C or M, Type S or S-LW

Reliability, Support, Delivery

BETA has over 30 years experience producing a wide range of aluminum and stainless steel pressure vessels for filtration, water separation, surge suppression, and fuel treatment. BETA has developed & supplied 1000's of filtration vessels qualified to the most stringent specifications, specifically API/ EI 1581 6th Edition specifications and procedures for aviation jet fuel filter/separators.

Aluminum vessels are ideal for mobile applications due to their light weight (up to 1000 lbs. less than carbon steel), low maintenance (no epoxy recoating) and resistance to corrosion.

**FOR A FREE QUOTE OR MORE INFO,
CONTACT US AT:**

Email: Sales@betafueling.com

Phone: +1 336 342 0306

Standard Design:

- EI 1596 Design & Construction
- Welded Aluminum construction—other materials available on request
- ASME Code, Section VIII construction
- Design pressure: 150 psi @ 150°F—other design pressures available on request
- Inlet, outlet and drain connections permanently marked
- Inlet/Outlet: Sample and drain ports.
- Sump Drain NPT Tapped.
- Interior/Exterior: Chromate Coating
- Swing bolt head closures
- Hinged end opening cover furnished on 16", 24" and 28" Series
- Victaulic inlet and outlet connections
- Buna-N O-ring closure seal

Options:

- ANSI Flanges (3", 4" or 6")
- Sump: Float or Removable Flange
- 4" Clean out / Inspection Flange
- Left hand Door opening
- Tangent or Elbow Inlet/Outlet

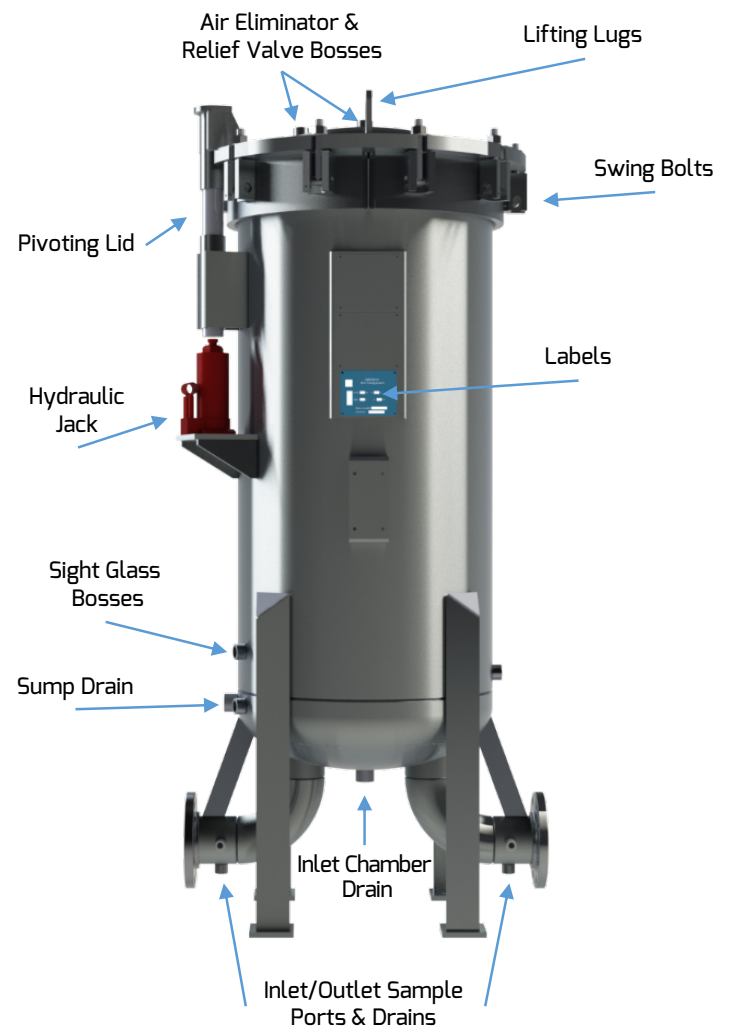

A24000V - 6005 - AE4 - Z001 -shown

Vessel Accessories

Pressure Relief Valve: (Mandatory)

Valve set at pressure, maximum of 100% of the vessel rating, to relieve excess pressure built up in the system from thermal expansion when fuel is not flowing.

Hydraulic Jack

Facilitates lid removal.

Float Control

Rides the interface between fuel and water, and by its up and down movement, opens and closes ports to generate hydraulic signals to automatic valves.

Sight Glass

Indicates fuel/water interface level.

Manual Drain (Mandatory)

ATA103 Requires these to be slumped daily to remove any accumulated water and to sample the fuel in the sump.

Slug Valve

Will shut down the vessel in an event of excessive water build-up when used with a float control. The slug valve can also be used as a flow controller to limit flow through the filter water separator.

Check Valve

Stops air from entering into the vessel through the air eliminator.

Automatic Air Eliminator (Mandatory)

Allows air to vent during filling of vessel. When fuel reaches the air eliminator, it automatically closes.

Separator Elements (Mandatory)

Repels water droplets and prevents them from leaving the filter vessel. Separated water is accumulated in the sump.

Coalescer Elements (Mandatory)

Removes solid contaminants and coalesces (enlarges) entrained water into droplets.

Differential Pressure Gauge (Mandatory)

Reads pressure difference between the inlet and outlet of a filter/separator which provides an indication of element condition.

Bulk Water Detector:

An Electronic sensor that detects water that has accumulated in the sump and sends an electronic signal to shut the system down or inform the operator.

Sampling Probe

The probes provide access to the fuel directly before and after the filtration for accurate samples.

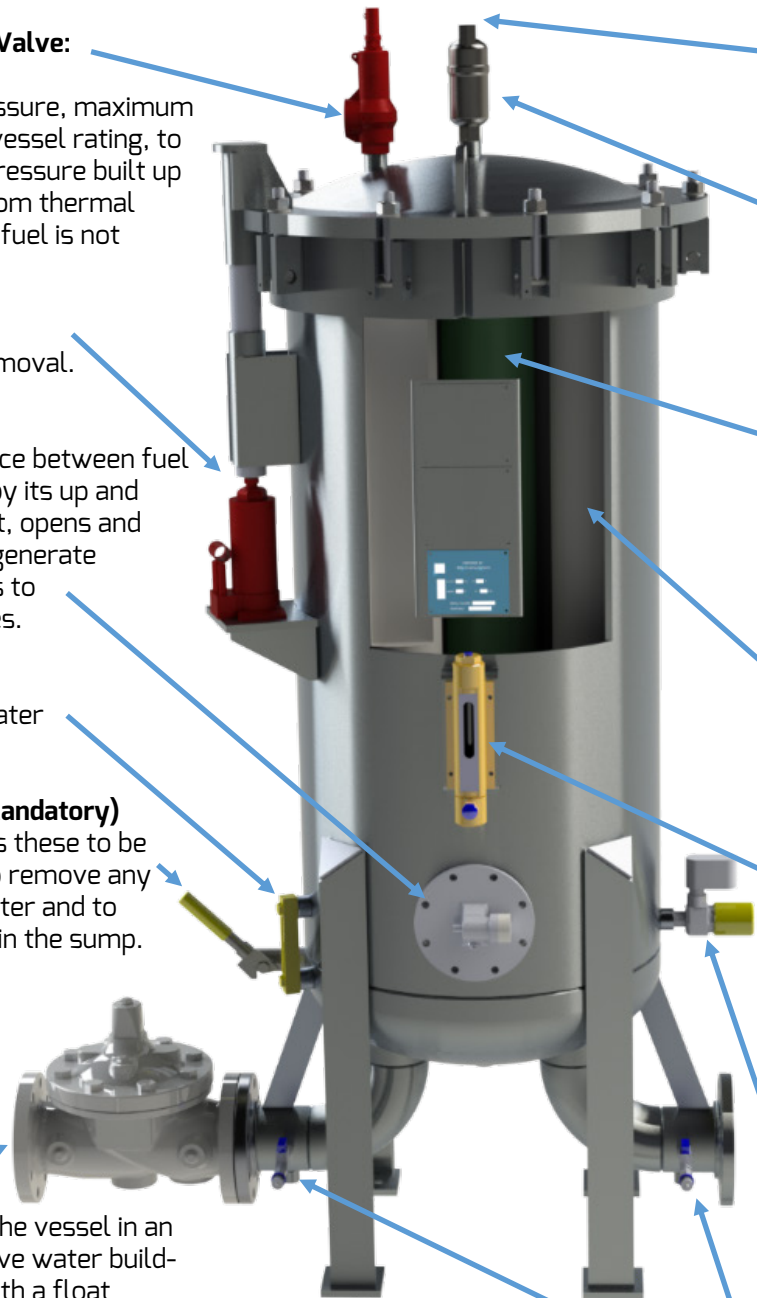

Horizontal Vessel Specs (Commercial)



Commercial Filter/Separators (Horizontal)
EI1581, 6th Edition, Category C, Type S & SLW

Dimensions subject to change. Updated dimensions and detailed drawings will be provided after receipt of PO.

AVIATION FUEL EI 1581, CATEGORY C, TYPE: S or SLW	MODEL NUMBER	FLOW RATE		CARTRIDGES				LENGTH (L)		INLET/ OUTLET SIZE	DIMENSIONS									
		GPM	LPM	COALESCER		SEPARATOR		in.	mm.		DIAMETER		C		D		E		G	
				QTY.	MODEL	QTY.	MODEL			in.	mm.	in.	mm.	in.	mm.	in.	mm.	in.	mm.	in.
SLW	A16XXXH-110SL-XX3-ZXXX	110	415.8	3	I-614C5TB	1	SO-417V5	40	1016	3	16	406.4	10	254	25.9	657	12.2	309	16.4	416
SLW	A16XXXH-240SL-XX3-ZXXX	240	907.2	3	I-628C5TB	1	SO-430V5	40	1016	3	16	406.4	10	254	25.9	657	12.2	309	16.4	416
SLW	A16XXXH-300SL-XX3-ZXXX	300	1134	3	I-633C5TB	1	SO-436V5	51	1295	3	16	406.4	10	254	25.9	657	12.2	309	16.4	416
S	A16XXXH-150S-XX3-ZXXX	150	567	3	I-622C5TB	1	SO-430V5	42	1067	3	16	406.4	10	254	25.9	657	10.2	260	16.4	416
S	A16XXXH-240S-XX3-ZXXX	240	907.2	3	I-633C5TB	1	SO-436V	51	1295	3	16	406.4	10	254	25.9	657	10.2	260	16.4	416
S	A16XXXH-315S-XX3-ZXXX	315	1190.7	3	I-638C5TB	1	SO-436V	53	1346	3	16	406.4	10	254	25.9	657	10.2	260	16.4	416
SLW	A24XXXH-380SL-XX3-ZXXX	380	1436.4	6	I-622C5TB	2	SO-623VA5	43	1092	3	24	609.6	10	254	18.4	467	13.6	345	17.0	432
SLW	A24XXXH-500SL-XX3-ZXXX	500	1890	6	I-628C5TB	2	SO-624V5	47.5	1207	3	24	609.6	10	254	18.8	476	15.4	391	17.0	432
SLW	A24XXXH-600SL-XX4-ZXXX	600	2268	5	I-633C5TB	3	SO-436V5	55.5	1410	4	24	609.6	12	305	26.8	679	15.4	391	17.0	432
SLW	A24XXXH-820SL-XX4-ZXXX	820	3099.6	6	I-644C5TB	2	SO-640V5	62.3	1581	4	24	609.6	12	305	33.5	851	15.4	392	17.0	432
SLW	A24XXXH-975SL-XX4-ZXXX	975	3685.5	6	I-656C5TB	2	SO-644V5	75.5	1918	4	24	609.6	12	305	46.8	1187	15.4	391	17.0	432
S	A24XXXH-305S-XX3-ZXXX	305	1152.9	6	I-622C5TB	2	SO-623VA5	43	1092	3	24	609.6	10	254	18.4	467	13.6	344	17.0	432
S	A24XXXH-380S-XX3-ZXXX	380	1436.4	5	I-628C5TB	2	SO-624V	47.5	1207	3	24	609.6	10	254	18.8	476	15.8	402	17.0	432
S	A24XXXH-455S-XX3-ZXXX	455	1719.9	6	I-628C5TB	2	SO-629VA	48.5	1232	3	24	609.6	10	254	19.8	502	15.8	402	17.0	432
S	A24XXXH-620S-XX4-ZXXX	620	2343.6	5	I-644C5TB	2	SO-630VA	62.3	1581	4	24	609.6	12	305	33.5	851	15.4	392	17.0	432
S	A24XXXH-745S-XX4-ZXXX	745	2816.1	6	I-644C5TB	2	SO-644VA	62.3	1581	4	24	609.6	12	305	33.5	851	15.4	392	17.0	432
SLW	A28XXXH-1000SL-XX6-ZXXX	1000	3780	7	I-644C5TB	2	SO-640V	65.5	1664	6	28	711.2	16	406	33.9	861	15.9	404	20.1	511

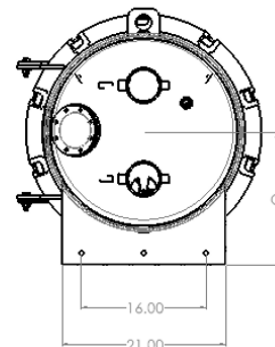
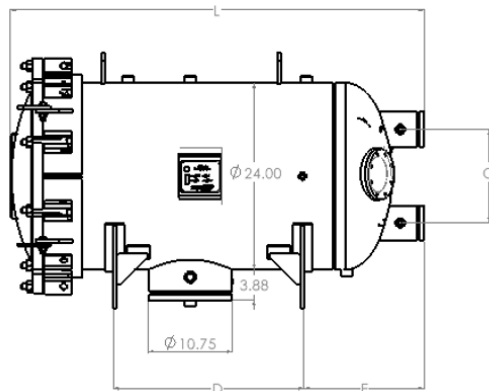
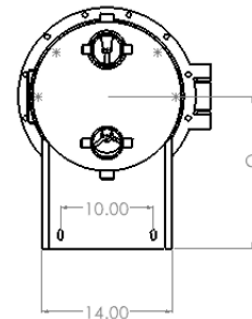
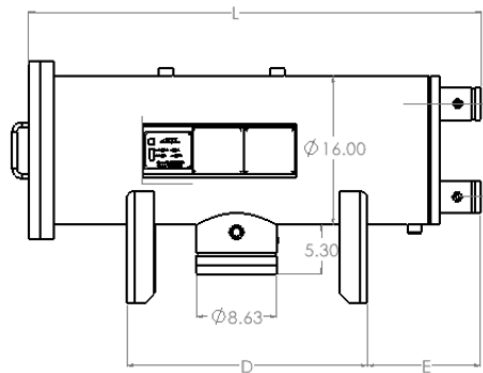



FUELING SYSTEMS



Contact us:

sales@betafueling.com or 336-342-0306